

## STANDARD FEATURES

SPA MODEL	FII745B
Seating Capacity	6
Acrylic	Basic
Dimensions (W x L x H)	84" x 84" x 39"
Dry Weight (Lbs.)	800 (363 kg)
Filled Weight (Lbs.)	4,340 (1,969 kg)
Water Capacity (Gal.)	425 (1,609 L)
High Performance Pump	2 x 2.0 HP
Pump(s) Voltage	240V
True Blue Vacuum Safety Break	Yes
<b>Total Jets:</b>	45
Euro Directional - 6 spoke (ED)	6
Euro Less Eyeball (ELE)	26
Micro Flow Directional - 6 spoke (mfc)	5
Polystorm Directional - 6 spoke (PSD)	8
2" Plumbing	Yes
Exclusive Bio Clean Filter™ Pop Up Filter Basket	50 sq. ft.
Spa Light (12V)	Yes
Exclusive Automatic Winterizing System 2" Plumbing	Yes
Exclusive "Green Pack" 40/50 Amp Equipment <small>(Only Available with 2 pump system) (N/A with XL Option in Classic Series)</small>	Yes
<b>Equipment &amp; Electrical</b>	5100 Equipment with Oval Topside
Flow-Through Heater (5.5kw)	Yes
Wall Drain	Yes
Pressure Treated Cabinet Frame	Yes
Cal Preferred Cabinet Panel	Yes
Cover, Basic 4" Taper to 2.5"	Yes
Standard Bottom Tray	Yes
UL , CEC and VGB Approved	Yes
Warranty (Structural)	3 Years
Warranty (Finish)	3 Years
Warranty (Parts)	3 Years
Warranty (Labor)	3 Years



## AVAILABLE OPTIONS

PLUMBING	
Stainless Steel Cobalt Blue Jets	OPT417-BLU-2
Waterfall, Cascade (WFV)	Opt-329
Waterfall, Vertical (VWF)	Opt-331
Cabinet Accessible Drain Valve	Opt-129
Gate Valve(s)	Opt-400
Turbo Air Injection (Adds 10 Air Jets)	Opt-800F2
EQUIPMENT	
110/220 Conversion Kit	Opt-102C
Ozonator	Opt-911
Spa LED light	OPT-112
LED Perimeter / Waterline Lighting	OPT-110
Stainless Steel Cobalt Blue Jets	OPT-139F
Stainless Steel Cobalt Blue Jets	Opt-860
Waterfall, 4" Oval (WF)	Opt-860P
Waterfall, Cascade (WFV)	Opt-S107
Waterfall, Vertical (VWF)	Opt-S106
Cabinet Accessible Drain Valve	Opt-S110
Gate Valve(s)	Opt-S101
Turbo Air Injection (Adds 10 Air Jets)	Opt-S105
110/220 Conversion Kit	Opt-S115
Ozonator	ELE09306000
Spa LED light	ELE09307000
LED Perimeter / Waterline Lighting	Opt-196
RECOMMENDED ACCESSORIES	
Rock-It Cover Lift (Undermount)	ACC01601020
Comfort Steps Mist(Mi), Smoke(S) or Mahogany(M)	ACCOHS2( )
Cantilever Umbrella with Cross Base Rust(R), Navy(N) or Cream( )	ACC01800600( )
Cantilever Umbrella with Flat Base Rust(R), Navy(N) or Cream( )	ACC01800610( )
Starter Chemical Kit ( Bromine or Chlorine)	CHE07000290-B CHE07000295-C

## AVAILABLE OPTIONS

SHELL	
Standard Colors	Opt-211
Cover, Standard 5" Taper to 3"	Opt-136
Cover, Deluxe 5" Taper to 3"	Opt-133
CABINET	
ABS Bottom Tray (Adds approx. 2-3" in height)( 7' or 8' only)	OPT-247
Top Rail <small>(N/A on Cal Wicker &amp; Cal Choice Cabinets ; Adds approx 3" in width)</small>	OPT-991
Full Foam Insulation	Opt-600
Thermo-Layer Cabinet	Opt-829
2 Corner Side Cabinet Lighting (Cal Preferred cabinets only)	Opt-863-2
4 Corner Side Cabinet Lighting (Cal Preferred cabinets only)	Opt-863-4
2 Corner Under Cabinet Lighting (Cal Preferred cabinets only)	Opt-864-2
4 Corner Under Cabinet Lighting (Cal Preferred cabinets only)	Opt-864-4

LINE	FAMILY
MODEL	FII 745B
NUM	

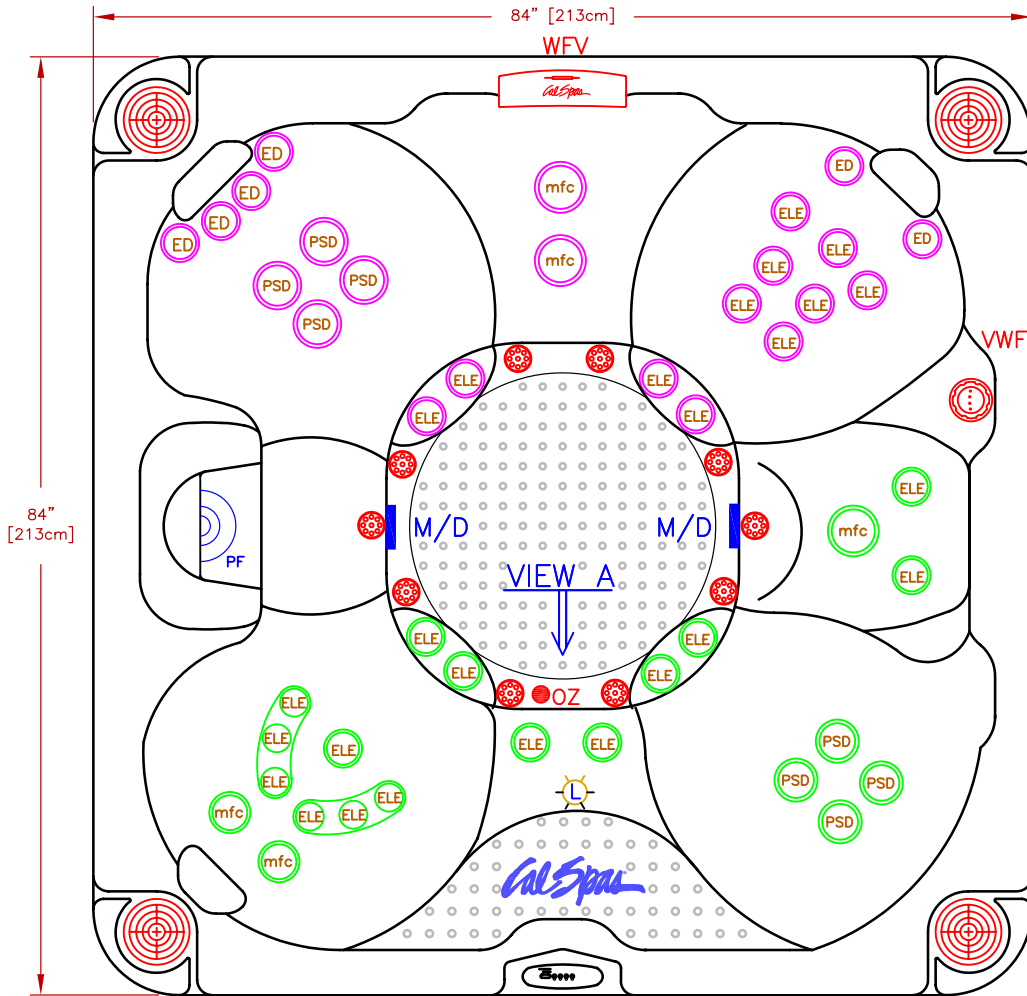

### 45 JETS LEGEND

QTY.	SYMB.	DESCRIPTION
5	(mfc)	MICRO FLOW DIRECTIONAL-6 SPOKE(PLU21703664)
6	(ED)	EURO DIRECTIONAL-6 SPOKE(PLU21703662)
26	(ELE)	EURO LESS EYEBALL-6 SPOKE(PLU21703663)
8	(PSD)	POLYSTORM DIRECTIONAL-6 SPOKE(PLU21703661)
1	(L)	LIGHT
2	(M/D)	MAIN DRAIN
1	(PF)	POP-UP FILTER (50 SQ.FT.)

- OPTIONS**
- = WATERFALL W/VALVE (WFV)
  - = VERTICAL WATERFALL (VWF)
  - = OPTIONAL STEREO SYSTEM (INCLUDES 4 SPEAKERS)
  - = OZONATOR (OZ)
  - = AIR INJECTORS

SCALE: N/A

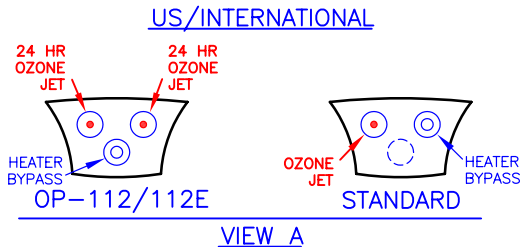

NOTE:  
DUE TO OUR CONTINUOUS IMPROVEMENT PROGRAM, ALL MODELS  
AND SPECIFICATIONS ARE SUBJECT TO CHANGE WITHOUT NOTICE.

SPECIFICATIONS	DIMENSIONS	84" X 84" X 35"
		213cmX213cmX89cm
	WATER CAP.	425 GAL [1,609 L]
	APP. WEIGHT	800 LBS [363 Kg]



TITLE		2010 SPA LINE FAMILY SERIES FII 745B
DWG NO.	DWG BY A. MORATAYA	
DATE	REVISED	
	11/18/09	